

BIG BIKE PARTS[®]

INSTALLATION INSTRUCTIONS

Copyright © 2022 by Big Bike Parts, Inc. No part of this instruction sheet may be reproduced without the written permission of Big Bike Parts, Inc.

PART NO. 17-454BK

INFERNO HEATED GRIPS

FITMENT: CAN-AM RYKER 2019-NEWER

2/16/2022

TOOLS NEEDED:	3MM ALLEN WRENCH	SANDPAPER 80-150 GRIT	GRIP GLUE (BBP#4-136)	RUBBING ALCOHOL/ALCOHOL WIPES
COMPONENTS INCLUDED:	RIGHT SIDE HEATED GRIP LEFT SIDE HEATED GRIP TEMPERATURE CONTROLLER ADHESIVE PAD ONE BUTTON CLAMP PLATE	ONE BUTTON CLAMP 7/8" RUBBER SPACER THROTTLE TUBE (INSTALLED IN RIGHT SIDE HEATED GRIP) FUSED WIRE HARNESS GRIP GLUE	M4-0.7X16MM LONG SOCKET HEAD CAP SCREWS (2)	

PLEASE READ THROUGH AND UNDERSTAND THESE INSTRUCTIONS BEFORE BEGINNING.

ESTIMATED INSTALLATION TIME: 60 TO 90 MIN.

SECTION ONE – INSTALLING GRIPS:

- IF YOUR BIKE HAS HANDLEBAR END WEIGHTS AND/OR STOCK MIRRORS, REMOVE THEM FROM BOTH SIDES AND SET ASIDE. (THESE WILL BE RE-USED)
- FROM THE RIGHT SIDE OF THE BIKE, REMOVE THE THREE SCREWS FROM THE MULTIFUNCTION SWITCH ASSEMBLY (FIG. 1). (THESE WILL BE RE-USED)
- CAREFULLY SEPARATE THE FRONT OF THE MULTIFUNCTION SWITCH ASSEMBLY AND MOVE OUT OF THE WAY FROM THE THROTTLE (FIG. 2). (DO NOT STRESS THE WIRES OR OTHER COMPONENTS INSIDE THE ASSEMBLY.)
- CAREFULLY REMOVE THE RIGHT GRIP AND THROTTLE SLEEVE TOGETHER BY PULLING STRAIGHT OUT FROM THE MULTIFUNCTION SWITCH ASSEMBLY (FIG. 2) WHILE NOTING THE ORIENTATION OF THE THROTTLE TUBE END.
- INSTALL THE RIGHT SIDE HEATED GRIP (WITH THROTTLE TUBE INSTALLED) (FIG. 3). BE SURE TO ORIENT THE NEW THROTTLE TUBE END CORRECTLY TO LINE UP WITH THE TAB INSIDE THE MULTIFUNCTION SWITCH ASSEMBLY.
- REPEAT STEP 3 AND 4 IN REVERSE ORDER TO REASSEMBLE THE MULTIFUNCTION SWITCH. (BE SURE TO LINE UP THE TAB ON THE MULTIFUNCTION SWITCH WITH THE HOLE IN THE HANDLEBAR WHEN INSTALLING)
- FROM THE LEFT SIDE, REMOVE THE LEFT GRIP BY SLIDING IT OFF THE END OF THE HANDLEBAR (FIG. 4). IT MAY HELP TO TWIST THE GRIP ON THE HANDLEBAR AS YOU PULL TO REMOVE IT.
- USING A STRIP OF 80-150 GRIT SANDPAPER, LIGHTLY SAND THE LEFT HANDLEBAR (FIG. 5) AS WELL AS THE INSIDE OF THE LEFT HEATED GRIP. (FIG. 5) ONLY SAND ENOUGH TO SCUFF THE SURFACES. **DO NOT OVER SAND OR FITMENT MIGHT BE AFFECTED.**
- CLEAN THE LEFT HANDLEBAR AND THE INSIDE OF THE LEFT HEATED GRIP WITH RUBBING ALCOHOL AND LET DRY COMPLETELY.
- SPREAD A THIN LAYER OF GRIP GLUE EVENLY ALL THE WAY AROUND THE HANDLEBAR (FIG. 5) STARTING APPROXIMATELY 1 INCH FROM THE END OF THE HANDLEBAR TO 2/3 THE LENGTH OF THE GRIP. (FIG. 5)
- TAKE THE NEW LEFT GRIP AND IN ONE MOTION, (WITHOUT STOPPING) SLIDE IT INTO POSITION ON THE HANDLEBAR. SLIGHTLY ROTATING THE GRIP ON THE HANDLEBAR AS YOU SLIDE IT ON WILL HELP SPREAD THE GLUE. MATCH THE ORIENTATION OF THE LEFT GRIP TO THE RIGHT GRIP FROM STEP 6. **DO NOT STOP MOVING THE GRIP UNTIL IT IS IN POSITION OR THE GLUE WILL SET AND YOU WILL NOT BE ABLE TO MOVE IT.**
- REINSTALL THE OEM MIRRORS AND ANY OTHER ACCESSORIES FROM STEP 1 TO THE ENDS OF THE HANDLEBARS.
- PICK A POSITION TO MOUNT THE TEMPERATURE CONTROLLER. FIND A GOOD LOCATION AND ATTACH THE CLAMP TO THE HANDLEBAR. (FIG. 6) IF YOU ARE MOUNTING THE CONTROLLER TO A DIFFERENT FLAT SURFACE FIND A GOOD LOCATION TO MOUNT THE CONTROLLER THAT YOU CAN REACH WHILE RIDING.
- CLEAN THE FAIRING AREA OR THE FACE OF THE HANDLEBAR MOUNT WITH RUBBING ALCOHOL AND LET DRY.
- PEEL ONE SIDE OFF OF ADHESIVE PAD SUPPLIED WITH THE GRIPS AND ATTACH IT IN THE LOCATION YOU CLEANED. **BE SURE ORIENTATION OF ADHESIVE PAD IS CORRECT FOR POSITION OF TEMPERATURE CONTROLLER.**
- CLEAN THE BACK OF THE TEMPERATURE CONTROLLER WITH RUBBING ALCOHOL, LET DRY AND ATTACH IT TO THE OTHER SIDE OF THE ADHESIVE PAD.
- ROUTE THE WIRES FROM THE TEMPERATURE CONTROLLER AND EACH GRIP TO A COMMON LOCATION AT THE FRONT OF THE BIKE. TRY TO FIND A LOCATION THAT THE CONNECTORS WILL BE PROTECTED FROM THE ELEMENTS. LEAVE ENOUGH WIRE LOOSE ON THE THROTTLE SIDE SO THAT IT CAN BE ROTATED AS MUCH AS NEEDED FOR FULL THROTTLE RANGE. **BE SURE THAT WHEN RELEASED, THE THROTTLE SNAPS BACK TO IDLE POSITION ON ITS OWN WITH NO RESISTANCE.**
- CONNECT EACH GRIP TO EACH BLUE AND WHITE CONNECTOR ON THE END OF THE TEMPERATURE CONTROLLER WIRE HARNESS.
- CONNECT THE FUSED WIRING HARNESS TO THE BATTERY OR TO A KEYED POWER SOURCE. CONNECT THE RED WIRE TO A POSITIVE SOURCE AND THE BLACK WIRE TO A GROUND. (BBP RECOMMENDS USING AN ISOLATION FUSE BLOCK BBP P/N 41-403- WHEN ADDING ELECTRICAL ACCESSORIES) IF CONNECTING THE GRIPS DIRECTLY TO THE BATTERY, THEY WILL NOT SHUT OFF WHEN THE BIKE IS SHUT OFF SO YOU WILL NEED TO MANUALLY TURN OFF WITH THE TEMPERATURE CONTROLLER.
- ROUTE THE WIRES FROM THE FUSED WIRE HARNESS TO THE COMMON AREA FROM STEP 17 AND ATTACH THE CONNECTOR TO THE RED AND BLACK WIRED CONNECTOR ON THE TEMPERATURE CONTROLLER HARNESS.
- USE ZIP TIES (NOT INCLUDED) IF NEEDED TO HOLD THE WIRING IN PLACE. TURN HANDLEBAR AS FAR RIGHT AND LEFT AS POSSIBLE TO MAKE SURE WIRING HAS ENOUGH SLACK AND DOES NOT BECOME TIGHT OR PINCHED.

SECTION TWO – OPERATING TEMPERATURE CONTROLLER

- TO TURN TEMPERATURE CONTROLLER “ON” PRESS AND HOLD THE BUTTON DOWN FOR TWO SECONDS. ALL FIVE LIGHTS WILL COME ON. THE GRIPS WILL BE ON THE HIGHEST SETTING.
- TO LOWER THE TEMPERATURE PRESS THE BUTTON ONE TIME FOR EACH LEVEL YOU WANT TO LOWER THE HEAT SETTING.
- TO TURN THE GRIPS “OFF” PRESS THE BUTTON UNTIL ALL OF THE LIGHTS ARE OFF.

“BATTERY SAVER MODE”

- THIS CONTROLLER COMES WITH THE BATTERY SAVER MODE TURNED OFF. THE BATTERY SAVER MODE WILL TURN THE GRIPS OFF IF THE INPUT VOLTAGE DROPS BELOW 12.5VDC.
- TO TURN “ON” THE BATTERY SAVER MODE PRESS AND HOLD THE BUTTON FOR 8 SECONDS. THE LIGHTS WILL LIGHT UP ONE AT A TIME FROM LOW TO HIGH. ONCE ALL THE LIGHTS ARE ON RELEASE THE BUTTON.
- TO TURN THE BATTERY SAVER MODE “OFF” REPEAT STEP 5 AND THE LIGHT WILL NOW GO FROM HIGH TO LOW. ONCE ALL LIGHTS ARE OFF RELEASE BUTTON.

CAUTION: HEATED GRIPS CAN GET EXTREMELY HOT WHEN USED TO MAXIMUM TEMPERATURE. PLEASE USE CAUTION WHEN USING HEATED GRIPS.

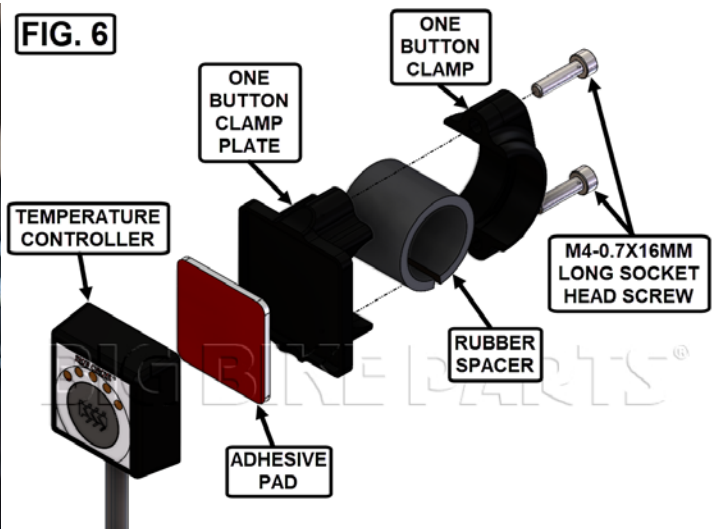
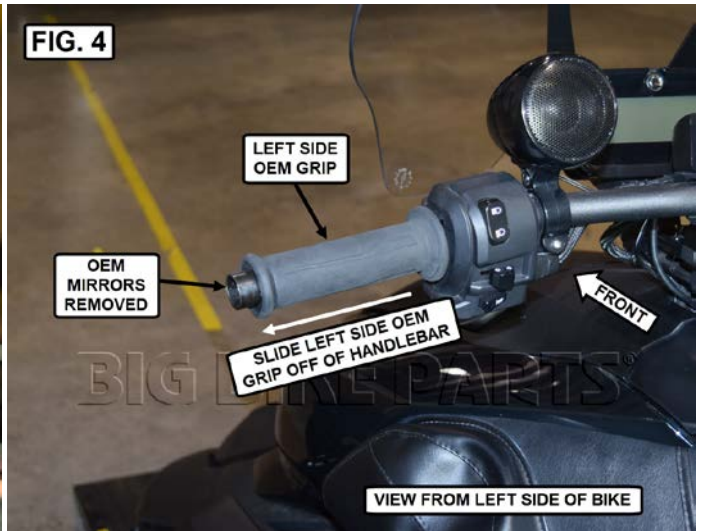
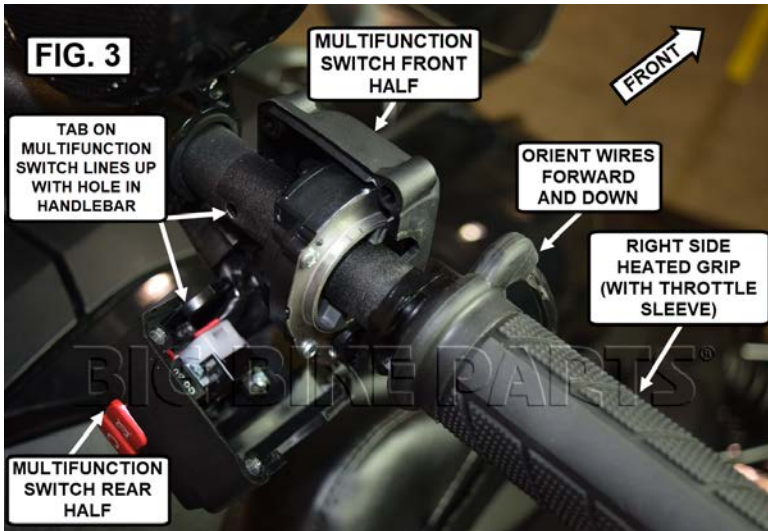
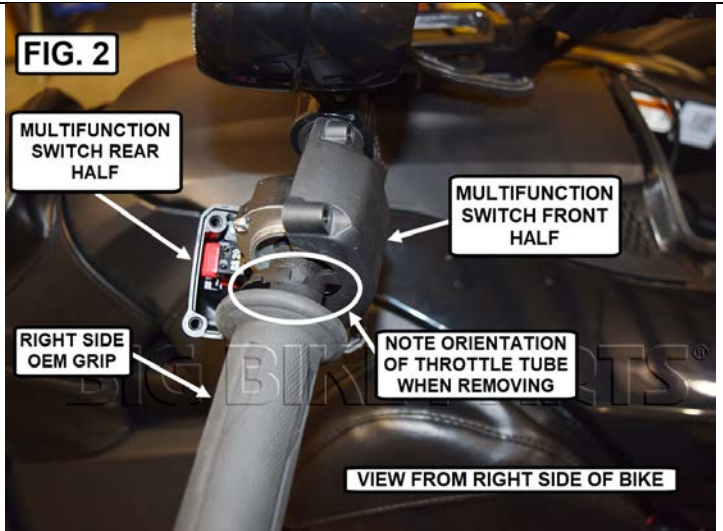
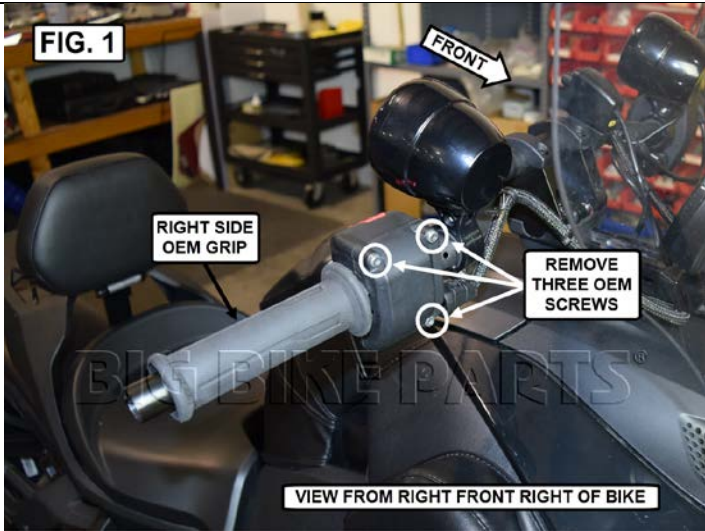

NOTICE

IGNORING THE CONTENTS OF THESE INSTRUCTIONS MAY AFFECT THE PRODUCT PERFORMANCE AND FUNCTIONALITY. NOT FOLLOWING THESE INSTRUCTION MAY CAUSE DAMAGE TO THE PRODUCT OR THE VEHICLE TO WHICH IT IS BEING ATTACHED.

NOTICE

CAN-AM RYKER

BIG BIKE PARTS RECOMMENDS INSTALLING AN ISOLATION FUSE BLOCK (PART NUMBER 41-403) BEFORE CONNECTING ANY ADDED ELECTRICAL ACCESSORIES TO THE RYKER.

WARNING

ALWAYS MAKE SURE THROTTLE ROTATES AND RETURNS BACK TO IDLE POSITION FREELY BEFORE OPERATING VEHICLE. FAILURE TO DO SO CAN RESULT IN INJURY