

# BIG BIKE PARTS®

Copyright© 2013 by Big Bike Parts, Inc.  
No part of this instruction sheet may be reproduced without the written permission of Big Bike Parts Inc.®

## INSTALLATION INSTRUCTIONS VANTAGE HIGHWAY BOARD SETS UNIVERSAL 1" & 1 1/4" BAR PART # 21-335, 21-336

Revised 08/13/13

TOOLS NEEDED: 8 MM ALLEN WRENCH, 5 MM ALLEN WRENCH, THREAD LOCK COMPOUND

NOTE: THREAD LOCK COMPOUND SHOULD BE USED ON ALL HARDWARE.

**NOTE: BE AWARE THAT IMPROPER POSITIONING MAY REDUCE CORNERING CLEARANCE. DO NOT MOUNT IN A POSITION THAT MAY REDUCE ANY SAFE CLEARANCE.**

1. STARTING ON THE RIGHT SIDE, CLEAN THE AREA ON THE HIGHWAY BAR WHERE YOU WANT TO MOUNT THE BOARD.
2. ASSEMBLE THE TWO CLAMPS ON THE TUBE AS SHOWN IN THE DIAGRAM BELOW.
3. INSTALL THE FOUR M6-1.0 X 18MM LONG ALLEN BOLTS IN THE CLAMPS BUT DO NOT TIGHTEN.
4. PLACE THE SPACER ON THE M10-1.5 X 25MM LONG ALLEN BOLT.
5. INSERT THE M10 BOLT AND SPACER THROUGH THE HIGHWAY BOARD AND THREAD IT INTO THE CLAMP BUT DO NOT TIGHTEN. SEE DIAGRAM BELOW.
6. POSITION THE BOARD AT THE HEIGHT AND ANGLE YOU LIKE AND TIGHTEN ALL BOLTS.
7. REPEAT STEPS 1 THROUGH 6 ON THE LEFT SIDE.

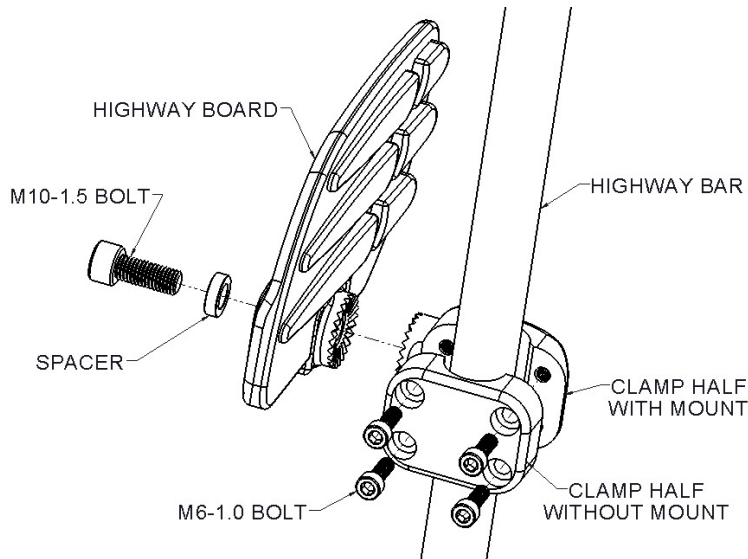

# BIG BIKE PARTS®

Copyright© 2013 by Big Bike Parts, Inc.  
No part of this instruction sheet may be reproduced without the written permission of Big Bike Parts Inc.®

## INSTALLATION INSTRUCTIONS VANTAGE HIGHWAY BOARD SETS UNIVERSAL 1" & 1 1/4" BAR PART # 21-335, 21-336

Revised 08/13/13

TOOLS NEEDED: 8 MM ALLEN WRENCH, 5 MM ALLEN WRENCH, THREAD LOCK COMPOUND

NOTE: THREAD LOCK COMPOUND SHOULD BE USED ON ALL HARDWARE.

**NOTE: BE AWARE THAT IMPROPER POSITIONING MAY REDUCE CORNERING CLEARANCE. DO NOT MOUNT IN A POSITION THAT MAY REDUCE ANY SAFE CLEARANCE.**

1. STARTING ON THE RIGHT SIDE, CLEAN THE AREA ON THE HIGHWAY BAR WHERE YOU WANT TO MOUNT THE BOARD.
2. ASSEMBLE THE TWO CLAMPS ON THE TUBE AS SHOWN IN THE DIAGRAM BELOW.
3. INSTALL THE FOUR M6-1.0 X 18MM LONG ALLEN BOLTS IN THE CLAMPS BUT DO NOT TIGHTEN.
4. PLACE THE SPACER ON THE M10-1.5 X 25MM LONG ALLEN BOLT.
5. INSERT THE M10 BOLT AND SPACER THROUGH THE HIGHWAY BOARD AND THREAD IT INTO THE CLAMP BUT DO NOT TIGHTEN. SEE DIAGRAM BELOW.
6. POSITION THE BOARD AT THE HEIGHT AND ANGLE YOU LIKE AND TIGHTEN ALL BOLTS.
7. REPEAT STEPS 1 THROUGH 6 ON THE LEFT SIDE.

